

-Project Name

broken chevron

-Location

Pointer 35° 43'31.67"
N105° 55'143.04"W
elev2239m

(461 Circle Drive, Santa Fe, New Mexico)

-Completion Date

Mayan Long Count
12•19•12•10•10

(August 30th 2005)

-Gross Area

295,200 square inches

(1,800 square feet)

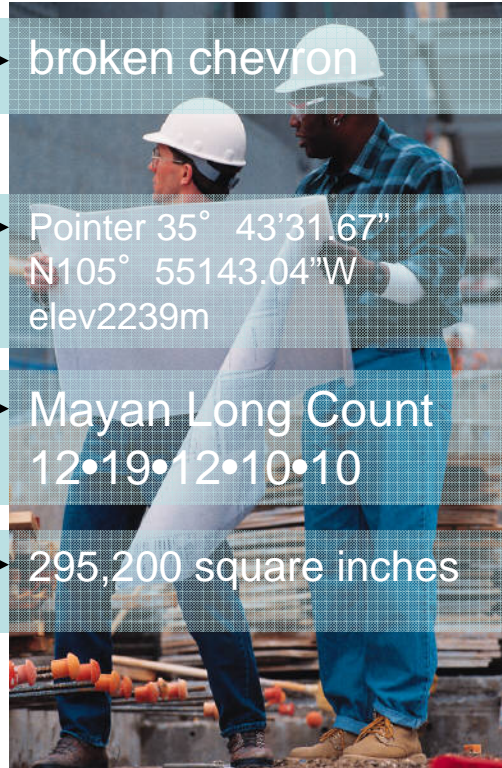

“Blank Presentation”

"Clipboard"

A simple Architectural definition of Contemporary could be the search for new within an existing context. You can do that many different ways, like on the "Project Title Side". The Project Name is not a person; it's a thing, an object that formally describes Architectural action and device. The Location is a Google Earth Pointer. The Completion Date is off the Mayan Calendar. The Gross Area is calculated in square inches instead of square feet: another frame of reference that distorts how we view size.

I want to throw in a quote from your Call For Entries, "*Jeff firmly believed that the continued development of new architectural ideas is the only way to sustain the vibrancy, texture and reality of a community.*" Nice, that's good stuff. That's a precept that all Architects should follow well past "do no harm" - a milquetoast for another blog. Anyway, back to Contemporary. My argument is that we are at the point of viewing the notion of Contemporary as just another style, equal to Santa Fe Style, Pueblo Style, International Style, Green or Victorian. Adding vigas does not make it Santa Fe. Wrapping a volume in steel and glass does not make it Contemporary.

Jeff's belief is great; it allows you to look at a context that is informed by community and by extension the individual. It allows the form to be motive, adjustable and specific to a time, place and location. That's good stuff - good Architecture.

So, a few words about the project that follows. It's a small house for a young couple on a difficult site. They were able to purchase the property for a lower cost because they were able to see possibilities. It's "Green": Stucco, Autoclaved Aerated Concrete, Recycled Steel, Rammed Earth and Radiant Heat/Cool. It is by no means perfect but does represent the ideals that Jeff was referring to. An ongoing dialog into what it means to be part of the Community of Santa Fe, both as Architectural context and as part of the human dynamic of Santa Fe.

On a more playful note, I have Included Clip Art and various Slide Designs from Microsoft's Power Point. I will try to keep the commentary on them to a minimum, but I can't help myself with a quick example. You saw the picture of the Contractors on the "Project Tile Slide". They look like Contractors sure, but the pants are not pressed right and the shoes are too clean. They are most likely Actors working in a context, representing Contractors. As to the different Power Point Designs, please think about them as different Styles, from "Clipboard" to "Fishbowl" they are just another way to look at the ideal of Contemporary.



These were some of the first models of the building. We thought they were a good start, but the owner was not on the final angle of the Chevron. Some nice ideas about the Rammed Earth and Entry came out of this Model Set. You can see the attached Metal Carport held off the rammed earth walls.

“Corrugated”



The Owner liked the reworking of the chevron here. It better matched their idea of view. This became the basis for the final design. This model shows the clear relationship between the rammed earth walls and the AAC walls and ceiling panels. The model shows an open glass entry with the small private garden at the rear.

“Fishbowl”





“Desk Lamp”

These CADD Models show the rammed earth entry and opening into the Living Room.

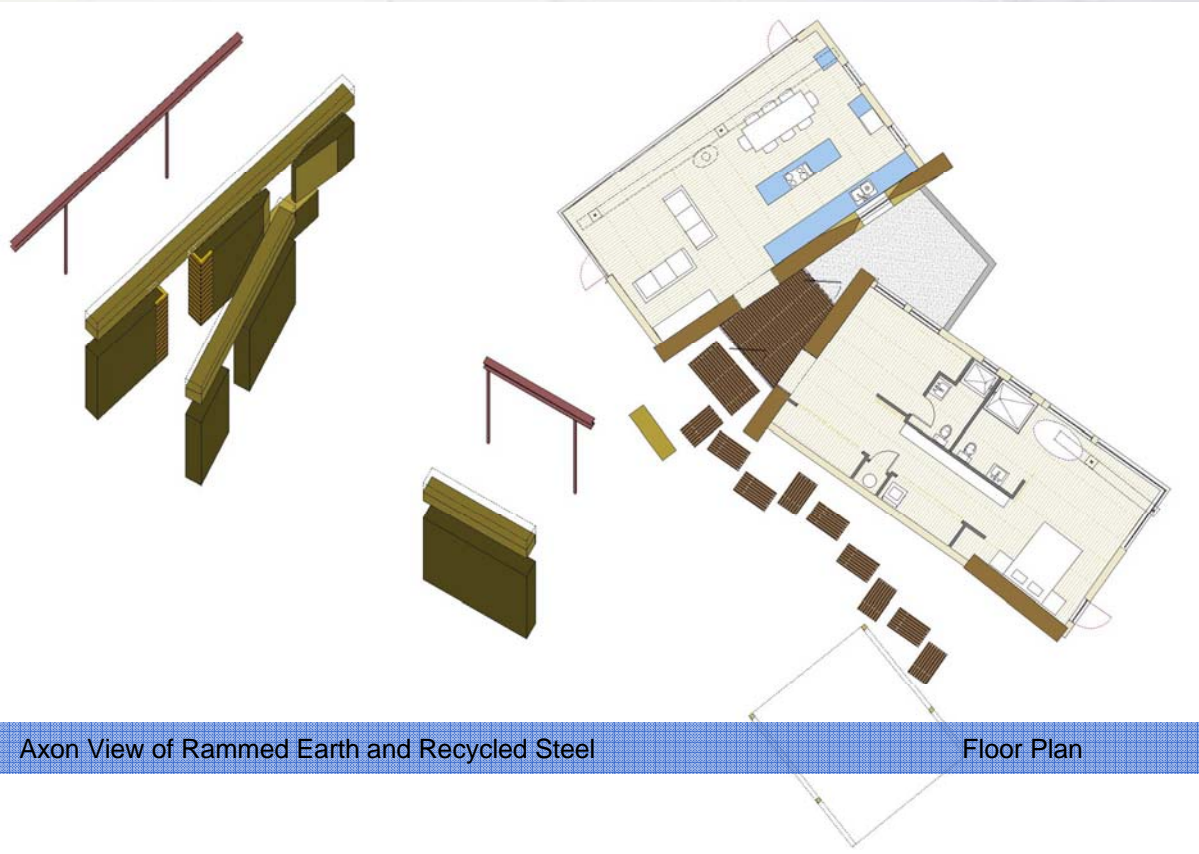

Axon View of Rammed Earth and Recycled Steel

Floor Plan

“Drafting”



Construction



Have to have some of the Architect's favorite shots. These show the rammed earth walls constructed first at the site

"Bold Stripes"



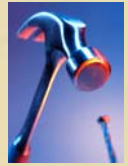

NO 2

Two more construction shots - I like these because you can clearly see the Autoclaved Aerated Concrete and closure of the glass across the front

“Writing Table”



Rammed Earth Entry



Open Bath

"Calm Seas"



View through Living Room

“Sakura”





Connection Detail of Recycled Steel Beam In Living Room with Glass Wall Behind

"Highway Sign